



MAY 22 2023

Catford Town Centre, changes to South Circular Road Summary of Proposals & Consultation Process

TfL Presentation to Catford South Local Assembly



EVERY JOURNEY MATTERS

Overview of Proposals

TfL and Lewisham Council have been working together on ambitions to improve Catford Town Centre and make it a more pleasant and attractive place for people to live, work and visit.

The key change which is currently being proposed as part of this is the relocation of part of Catford Road (part of the A205 South Circular Road) to a new route to the south of Laurence House and returning the gyratory system to two-way working. This will allow:

- The council to create a new public space in the town centre
- Improvements for pedestrians, cyclists and bus users
- Opportunities for improving the public realm with new planting and landscaping around the town centre.



Overview Map

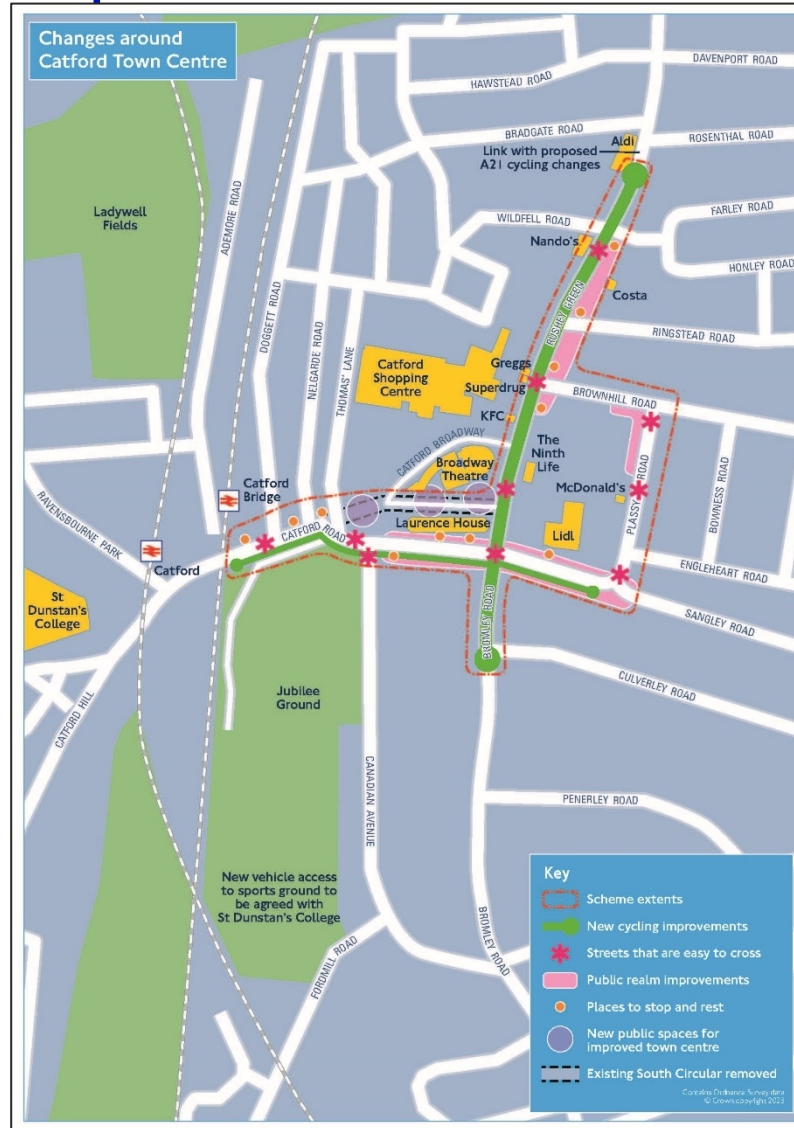

Changes to the South Circular Road (Catford Road)

The proposals aim to:

- Create a largely car-free town centre with improved pedestrian access to shops, leisure facilities and other local amenities – vehicle access for servicing/deliveries will remain as it is now
- Simplify the road network by removing the one-way system around Plassy Island, making it two-way
- Improve walking and cycling infrastructure with new segregated cycle lanes, pedestrian crossings and wider pavements
- Provide a new public space with trees and greening
- Accommodate Lewisham Council's Catford Town Centre Framework aspirations to transform Catford.



Changes for Cyclists

The proposals aim to:

- A new two-way segregated cycle lane along the new section of Catford Road
- New segregated cycle lanes along Rushey Green between Catford Road and Brownhill Road – new bus stop by-passes will provide pedestrian access to the bus stops
- A wider northbound bus lane on Rushey Green between Brownhill Road and Wildfell Road
- A new shared facility on the widened southern footway of Sangley Road
- New toucan crossings to improve access between the town centre, stations and the wider area
- Advanced Stop Lanes ('bike boxes') and signalised early release for cyclists at the new junction of Catford Road, Sangley Road and Bromley Road.



Changes for Pedestrians

The proposals aim to:

- Wider footpaths between Catford Bridge Station and the town centre
- A new light controlled pedestrian crossing over Catford Road at Catford Bridge station
- New light controlled pedestrian crossings over Catford Road near Thomas Lane, over Canadian Avenue and over Plassy Road at Sangley Road
- Improved light controlled pedestrian crossings in the town centre
- New light-controlled pedestrian crossings on all arms of the new junction at Catford Road, Sangley Road and Bromley Road
- Simplifying the junction of Rushey Green and Brownhill Road to introduce new 'straight across' pedestrian crossings to make crossing the A21 Rushey Green easier for pedestrians



Changes for Bus Passengers

- Removing the need for some bus routes to travel around the gyratory system will make some bus journeys quicker.
- We would need to relocate some bus stops in the town centre, which may affect journeys for people who travel to or through Catford town centre by bus.
- Some bus passengers may have a shorter walk, while others may have a longer walk from the bus stop to the shops and leisure facilities than they do now.
- We have produced a document summarising the changes to bus routes which travel through Catford Town Centre so that people can easily check their bus route for changes.



Local Environmental Issues/Consequences

- Local Air Quality - the scheme would reduce exposure to poor air quality in the town centre by moving traffic on the South Circular away from public areas and shops. We anticipate that the improvements to walking and cycling infrastructure will encourage more people to travel on foot, by bike or on public transport, helping to reduce the number of car journeys and associated vehicle emissions.
- - Tree removal/greening: in designing the scheme we have sought to minimise, the number of trees that will need to be removed. To compensate for any trees which need to be removed, the proposals include new trees and landscaping within the town centre. We will work with Lewisham Council to deliver a net increase in trees in Catford Town Centre.
- Parking – the Laurence House car park would be removed – the council are currently carrying out a staff travel survey and aim to reduce the number of staff travelling to work by car. Some on street parking spaces will also need to be removed including on Canadian Avenue and in Rushey Green.
- The new road layout would need to incorporate a small section of the St Dunstan's College Jubilee Ground. Alternative vehicle access and coach parking will be provided – the details of how this will be delivered are being agreed with the school.



Artists' Impression...



Purpose of the consultation

- **In delivering this consultation we aim to:**
- Fulfil our legal duty to conduct a public consultation on these proposed public transport service changes (bus changes)
- Provide stakeholders and the public with sufficient information about the proposals to allow them to give informed responses and suggestions
- Consult with representatives and members of protected characteristic groups that may be disproportionately impacted by proposals
- Understand reasons behind concerns and objections
- Identify new issues or impacts not already thought of
- Allow feedback from stakeholders and the public to influence our final decision about these proposals
- Consider suggestions that would help mitigate against adverse impacts should the changes go ahead
- Allow our decision makers to consider all responses fairly and equally



Consultation timelines

Catford Town Centre, changes to South Circular Road

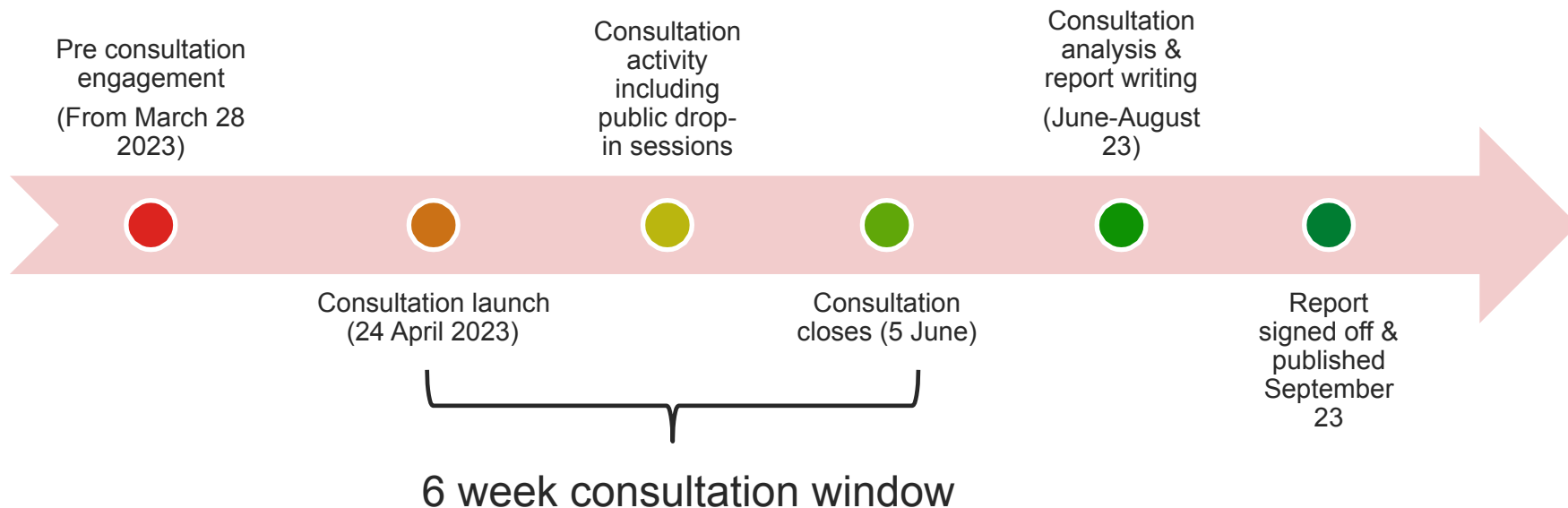

Consultation Publicity and Activities

At consultation launch:

- Letter drop to 6,000 addresses in town centre area
- Customer Relations Management (CRM) email to 32,000 email addresses, targeting registered Oyster card users with an SE6/SE13 postcode (who have consented to receive update emails from us)
- Email to all key borough stakeholders
- Press release and article on TfL sponsored page in 'Metro' newspaper.
- Council support with social media activity/internal comms to staff/other local comms channels
- 3D on-street publicity installed ('Toblerones') around gyratory

Activity during consultation:

- Face to face visiting shops/businesses around the gyratory and in the town centre to raise awareness and ask them if they'll display a consultation poster (first week of consultation)
- Proposed supply of paper materials and forms available at Catford Library throughout the consultation.
- Consultation drop-in sessions at various locations in areas impacted by consultation
- Attendance at relevant Local Assembly meetings

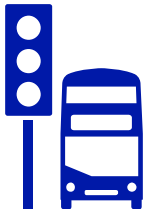

Consultation Maps

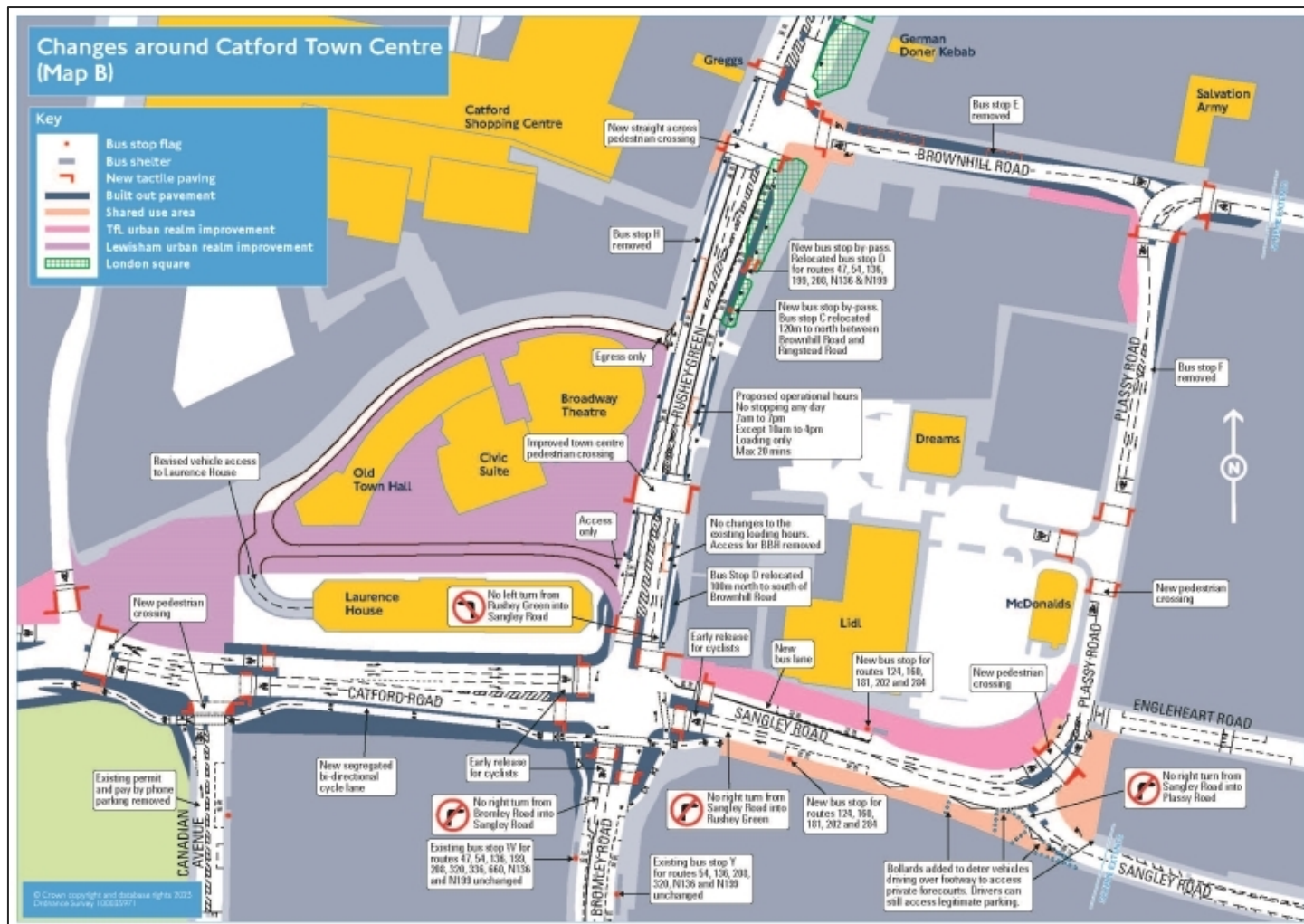

Consultation Materials – posters & advertising



**Your Catford.
Your say.**

We are proposing changes to the way people move around the town centre and would like to hear your views.

Have your say

Our proposals include changes to how the roads operate, including for buses, and improvements for people walking and cycling around Catford.

For more information and to have your say, please scan the QR code or:

Visit: haveyoursay.tfl.gov.uk/catford-town-centre
 Email: haveyoursay@tfl.gov.uk
 Telephone: 020 3054 6037 (call back service)
 Consultation ends Monday 5 June 2023

MAYOR OF LONDON

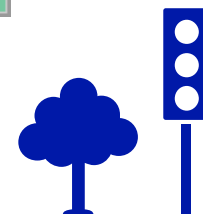

Catford Library Display

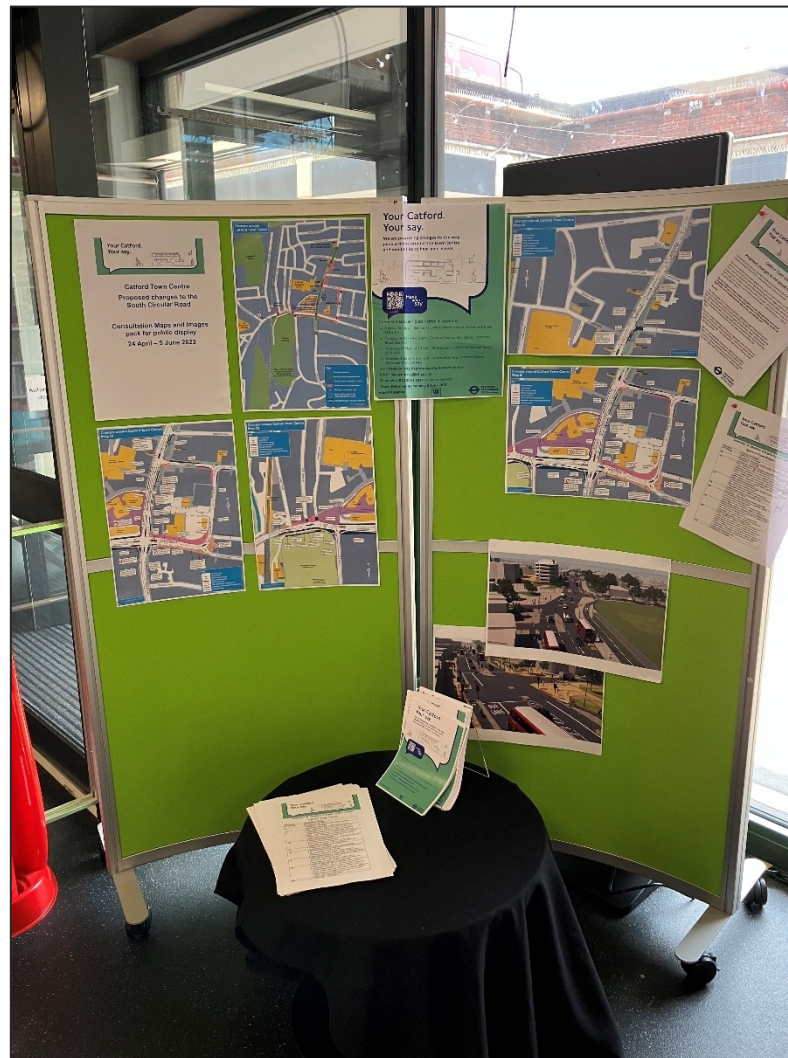

Consultation Website

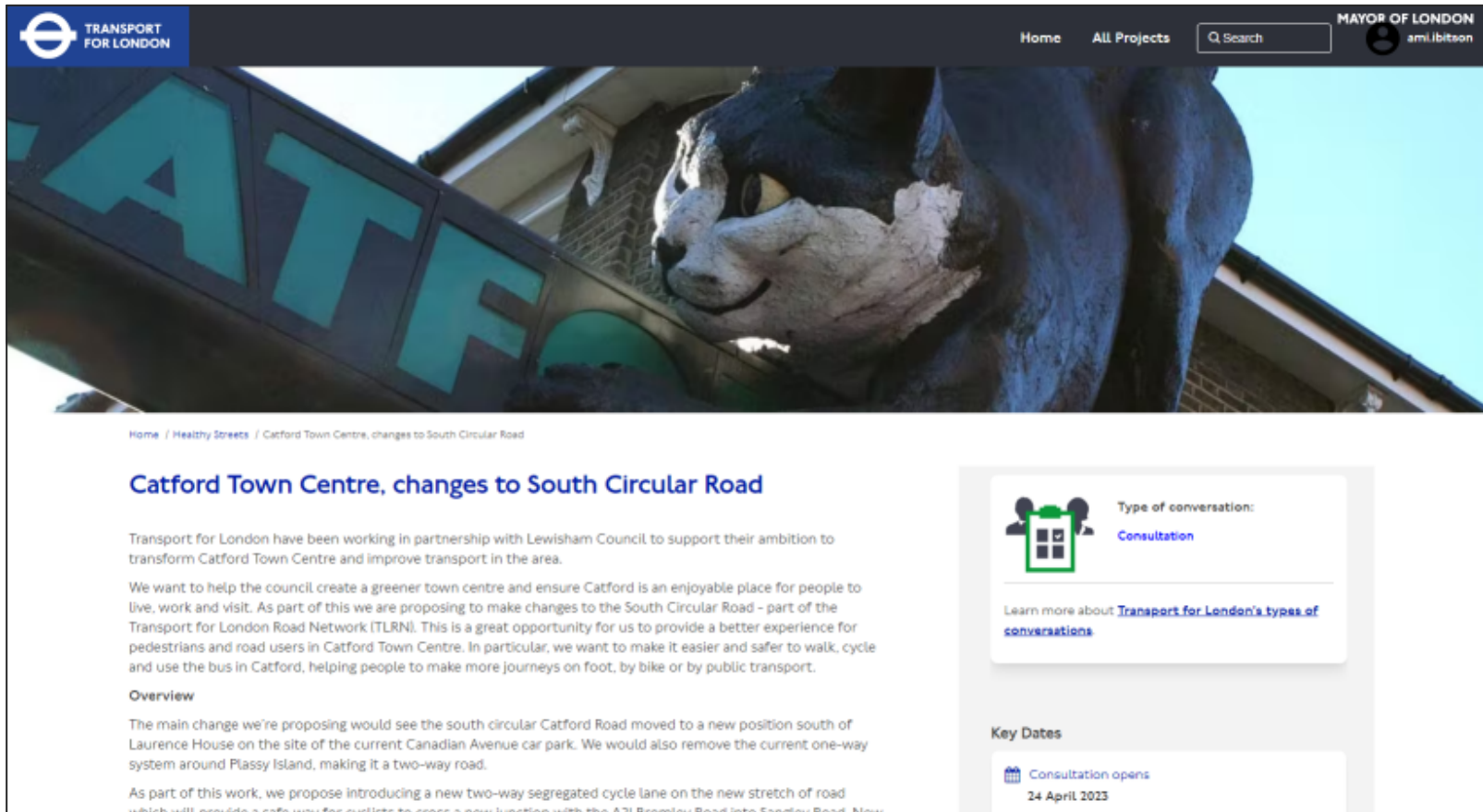

The screenshot shows the Transport for London website interface. At the top left is the Transport for London logo. The top right navigation bar includes 'Home', 'All Projects', a search box, and the Mayor of London's name 'ami.lbitson'. The main header image features a large blue bulldog sculpture and a sign with the letters 'ATF'. Below the image, the breadcrumb trail reads 'Home / Healthy Streets / Catford Town Centre, changes to South Circular Road'. The main heading is 'Catford Town Centre, changes to South Circular Road'. The text describes the partnership with Lewisham Council and the goal of creating a greener town centre. A sidebar on the right contains a 'Type of conversation' section with a 'Consultation' icon, a 'Key Dates' section with a 'Consultation opens 24 April 2023' date, and a link to 'Learn more about Transport for London's types of conversations'.

Home / Healthy Streets / Catford Town Centre, changes to South Circular Road

Catford Town Centre, changes to South Circular Road

Transport for London have been working in partnership with Lewisham Council to support their ambition to transform Catford Town Centre and improve transport in the area.

We want to help the council create a greener town centre and ensure Catford is an enjoyable place for people to live, work and visit. As part of this we are proposing to make changes to the South Circular Road - part of the Transport for London Road Network (TLRN). This is a great opportunity for us to provide a better experience for pedestrians and road users in Catford Town Centre. In particular, we want to make it easier and safer to walk, cycle and use the bus in Catford, helping people to make more journeys on foot, by bike or by public transport.

Overview

The main change we're proposing would see the south circular Catford Road moved to a new position south of Laurence House on the site of the current Canadian Avenue car park. We would also remove the current one-way system around Plassy Island, making it a two-way road.

As part of this work, we propose introducing a new two-way segregated cycle lane on the new stretch of road which will provide a safe way for cyclists to cross a new junction with the A71 Bromley Road into Sandey Road. New

Type of conversation:
Consultation

Learn more about [Transport for London's types of conversations](#)

Key Dates

Consultation opens
24 April 2023

The website includes:

- Online survey (registration required)
- Maps and Frequently Asked Questions
- Easy Read materials and a BSL video
- Equalities Impact Assessment
- Questions' tool for members of the public to ask for further information



Accessibility and Inclusion

We want our consultations to be as inclusive as possible and accessible to all.

- Our webpage is able to translate materials into a variety of languages
- All our consultations include Easy Read materials and surveys
- All our consultations include a British Sign Language video explaining the proposals
- Our on-street advertising (Toblerones) are positioned to be accessible to those using wheelchairs or mobility scooters
- We will provide paper copy, large print or other formats on request and will have these available at all in-person drop in events
- We produce an Equalities Impact Assessment for all consultations and this is available on the website, kept under review and updated using the results of the consultation to document impacts of the scheme (positive and negative) on those with protected groups
- We are engaging with a range of groups representing those with protected characteristics to ensure they have the opportunity to hear about the proposals and give their views.



How to Respond

- Visit [Haveyoursay.tfl.gov.uk/catford-town-centre](https://haveyoursay.tfl.gov.uk/catford-town-centre) and complete our online survey – registration with an email address required
- Respond in writing by:
 - Emailing Haveyoursay@tfl.gov.uk
 - Writing to FREEPOST TfL Have Your Say
- Telephone 020 3054 6037 to request a call back to:
 - Ask a question about the proposals
 - Request materials in an alternative format
 - Provide feedback if needed.



What happens next

- All feedback will be collated, uploaded onto our portal and sent for external analysis (all data is kept securely)
- Analysts will collate the results and produce a list of the issues raised by respondents which we will need to work with Lewisham colleagues to respond to – we currently anticipate around 1500 to 2000 responses.
- We will produce a consultation report, including a ‘Responses to Issues Raised’ report to be agreed by TfL and the council. The report will contribute to how decision makers decide the next steps.
- The report and next steps will be published – currently proposed for some time in September 2023 – and ‘close out’ the formal consultation process.



Why we welcome ALL feedback!

- Shows there has been a clear and open presentation of the proposals
- Ensures decision makers are able to take all feedback into account
- Can make decision makers aware of issues which may not have been thought of and so that mitigation of these can be considered
- Enables us to respond to issues raised and demonstrate this to the public

